

FOR LEASE

1 General Motors Drive

Syracuse, New York 13206

## SALINA INDUSTRIAL POWERPARK



## 10,789± SF Office Available

Private offices combine with ample open bull pen space, modern kitchenette and welcoming reception area to serve your office workforce and visitors. Superb natural light from modern insulated window walls compliment the extraordinary presence, easy access and extensive dedicated parking of this premier office location.

### Property Highlights

- Fiber Optics (FIOS, Level3)
- Efficient, Sustainable Mechanicals
- ADA Certified with Elevator
- 4 Car per 1,000 SF Parking
- 4 Zones 30 Ton HVAC
- Occupy within 30 Days of Lease Execution
- Ideal uses include professional office, medical, training facility, etc.



For more information, please contact:

**Paul B. Mackey**  
Real Estate Salesperson  
+1 315 382 8700  
pmackey@pyramidbrokerage.com

**John L. Clark, SIOR, CRE**  
President, Real Estate Broker  
+1 315 445 8509  
jclark@pyramidbrokerage.com

5786 Widewaters Pkwy, P.O. Box 3  
Syracuse, New York 13214  
phone: +1 315 445 1030

pyramidbrokerage.com

**FOR LEASE**

**1 General Motors Drive**

Syracuse, New York 13206

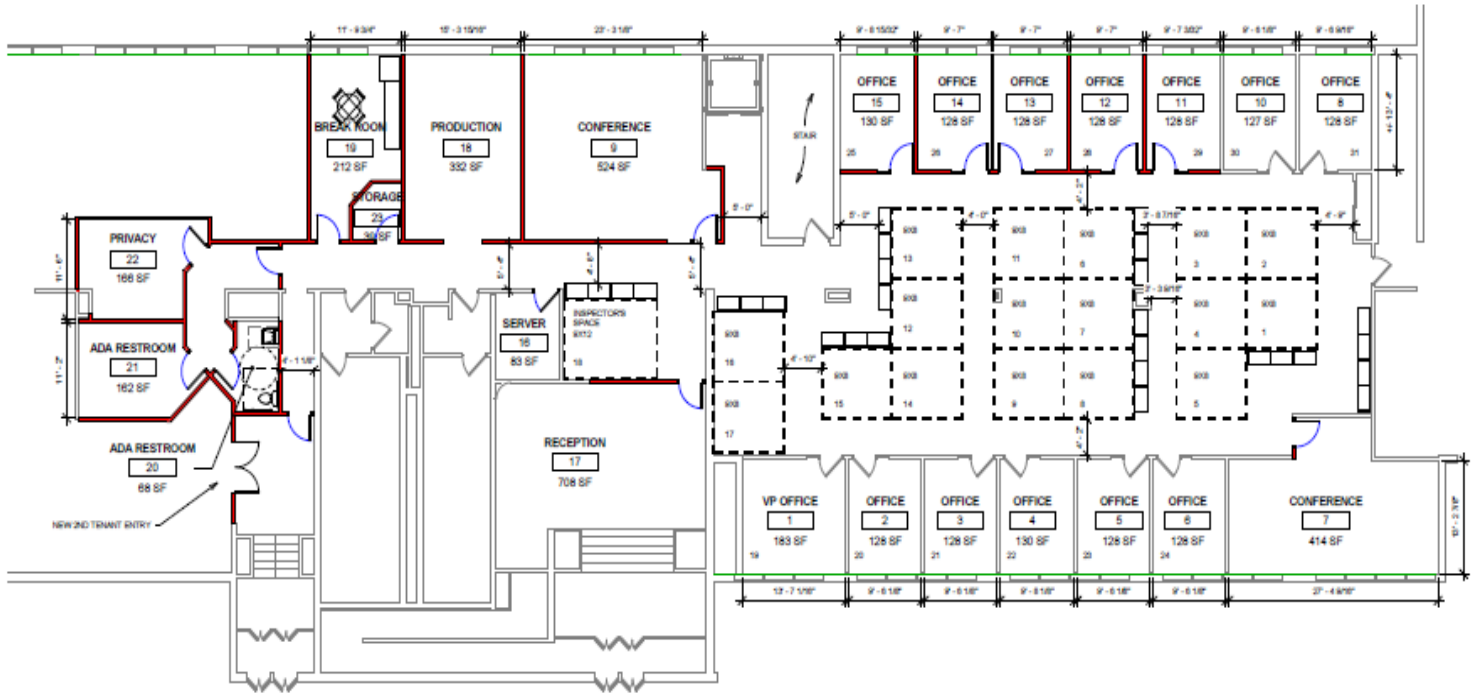

**Break Room**



**Large Welcoming Reception**

Planning an office move? Have the office Move go as planned! Salina Industrial Powerpark provides full service, turn-key, options in a perfect location!